

KEY NOTES

- 02 Structural Concrete Deck
- 23 Approved Insulation
- 36 Base Sheet Liner
- 38 Protection Sheet, Optional
- 39 Drainage Board with Fabric
- 41 Approved Primer
- 44 Tremseal D, Optional
- 51 AlphaGuard MT/MTS Base Coat
- 61 AlphaGuard Glass Mat or Permafab
- 71 AlphaGuard MT/MTS Top Coat
- 81 Paver
- 82 Paver Pedestal
- 96 Metal Coping
- 97 Prefabricated Curb

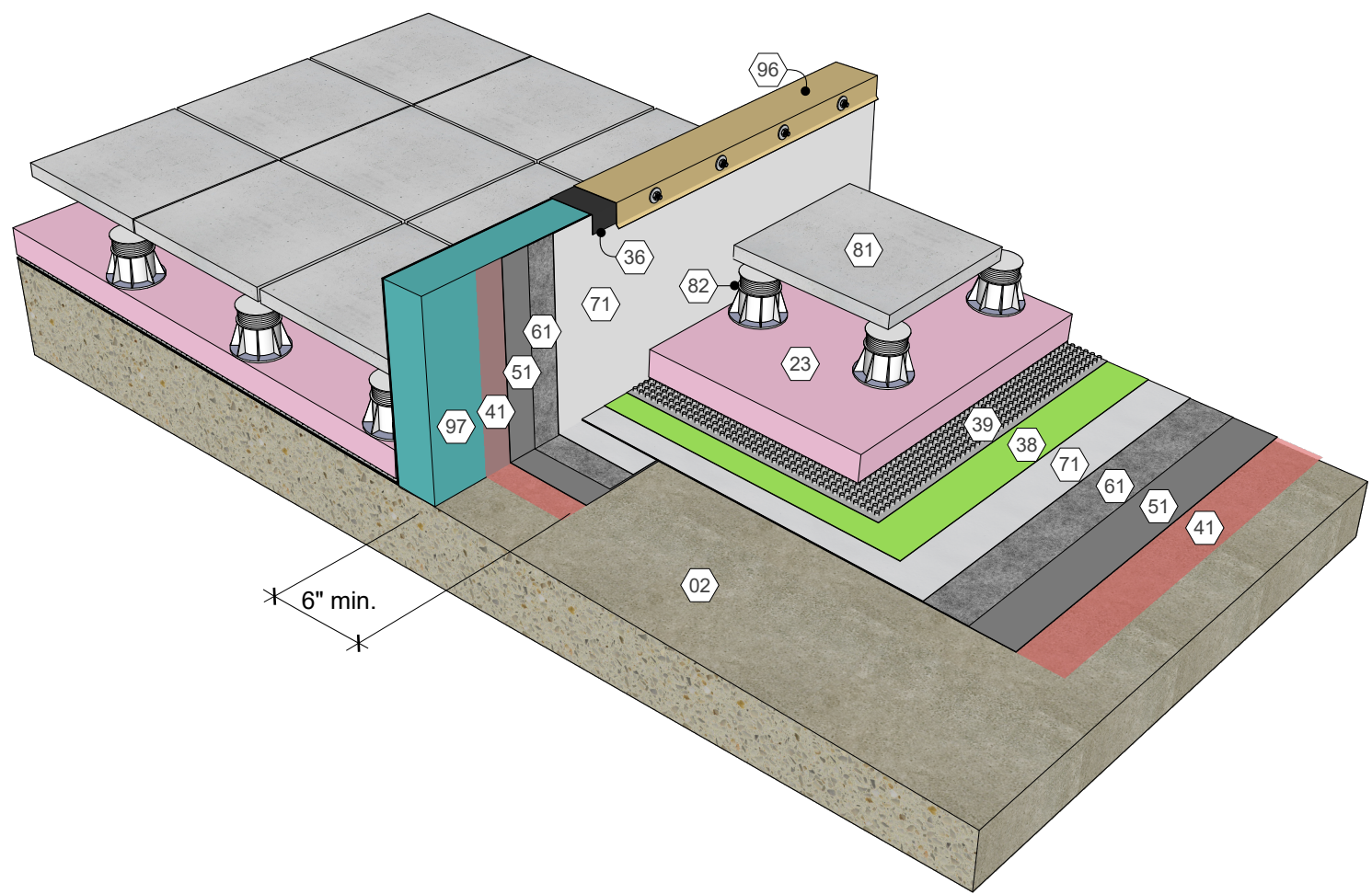

AlphaGuard MT/MTS Equipment Support Detail, Direct to Concrete
 Detail 10101



KEY NOTES

- 02 Structural Concrete Deck
- 23 Approved Insulation
- 36 Base Sheet Liner
- 38 Protection Sheet, Optional
- 39 Drainage Board with Fabric
- 41 Approved Primer
- 44 Tremseal D, Optional
- 52 AlphaGuard BIO Base Coat
- 61 AlphaGuard Glass Mat or Permafab
- 72 AlphaGuard BIO Top Coat
- 81 Paver
- 82 Paver Pedestal
- 96 Metal Coping
- 97 Prefabricated Curb

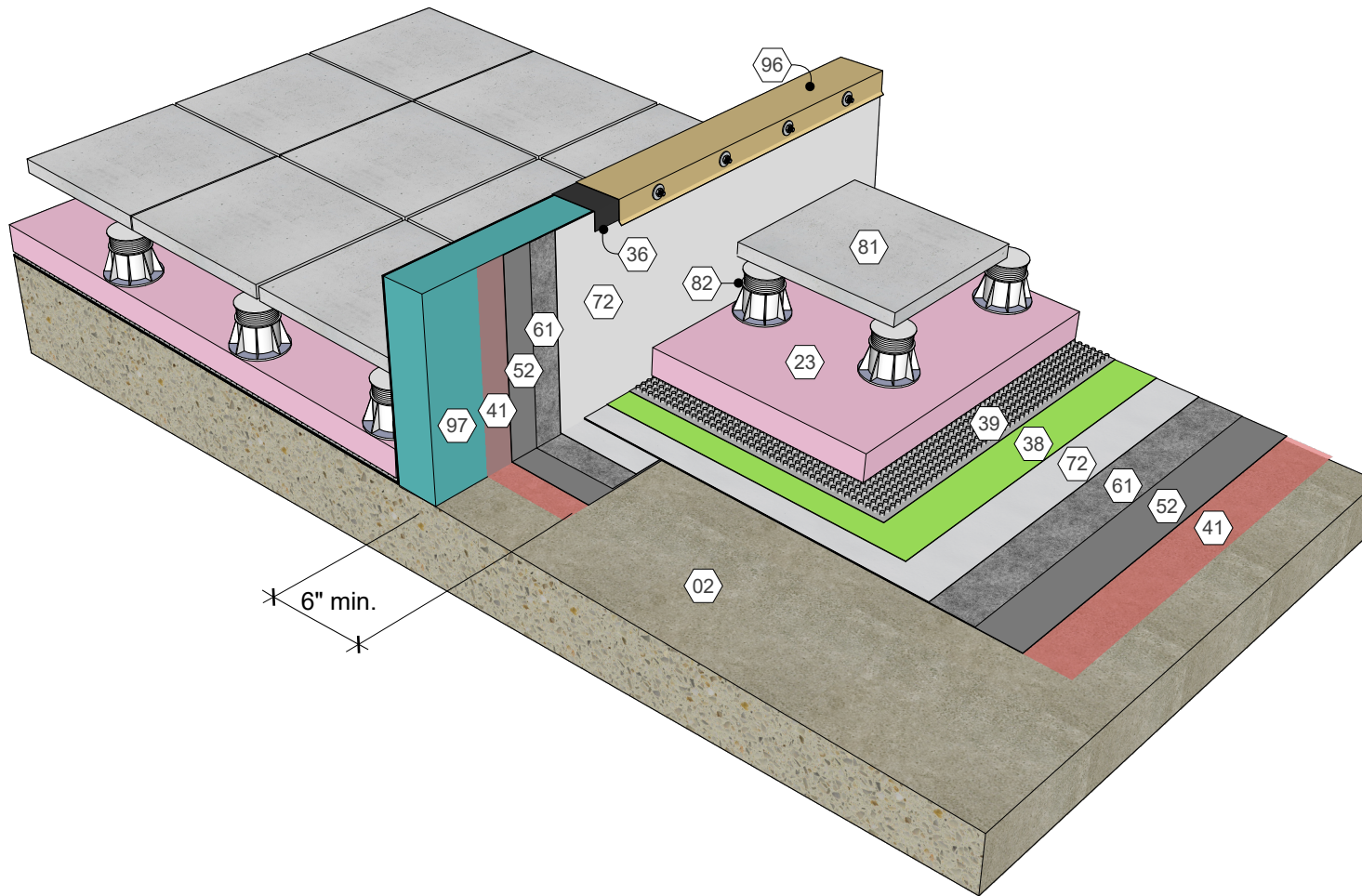

AlphaGuard BIO Equipment Support Detail, Direct to Concrete
Detail 10102

KEY NOTES

- 02 Structural Concrete Deck
- 23 Approved Insulation
- 36 Base Sheet Liner
- 38 Protection Sheet, Optional
- 39 Drainage Board with Fabric
- 41 Approved Primer
- 44 Tremseal D, Optional
- 53 AlphaGuard Puma Base Coat
- 61 AlphaGuard Glass Mat or Permafab
- 73 AlphaGuard PUMA Top Coat
- 81 Paver
- 82 Paver Pedestal
- 96 Metal Coping
- 97 Prefabricated Curb

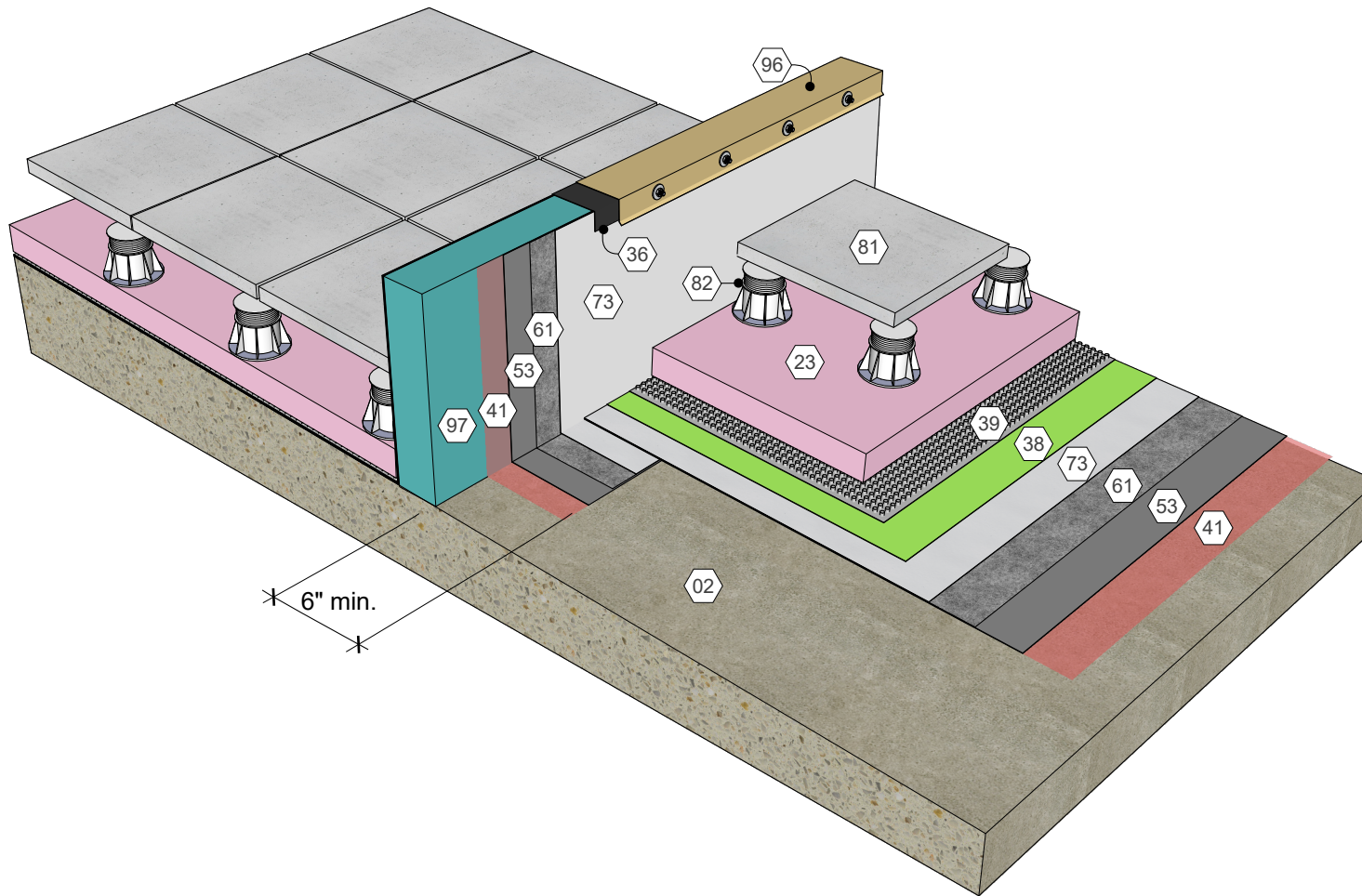

AlphaGuard PUMA Equipment Support Detail, Direct to Concrete
Detail 10103